

Battery Angle Drive with High Torque (1.5 to 6 V Operating Voltage / 1.3 to 16 rpm Rotation Speed)

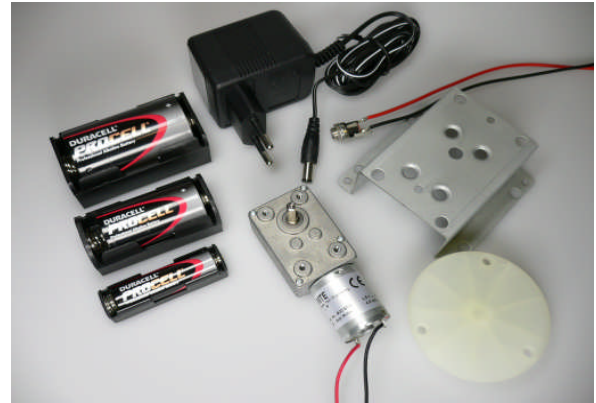

BWA Size Relation to One-Euro-Coin



BWA with Accessories

Dimensions of the Angle Drive in mm:

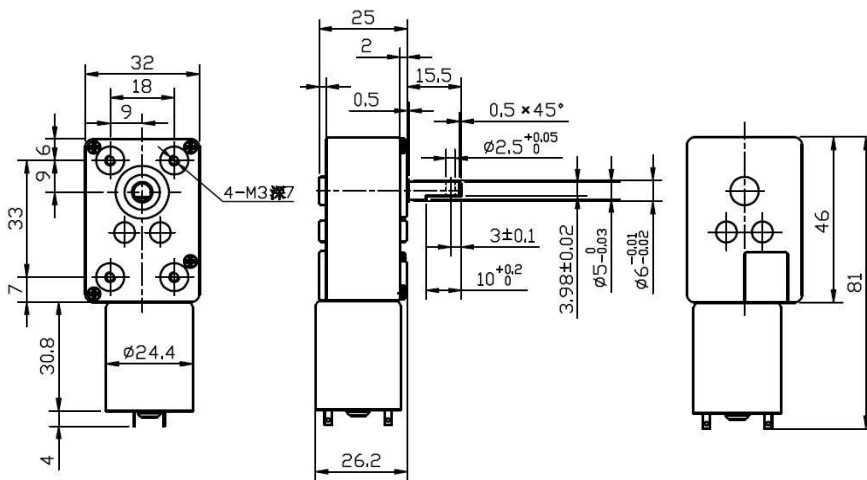

Dimensions of Motor Bracket in mm:

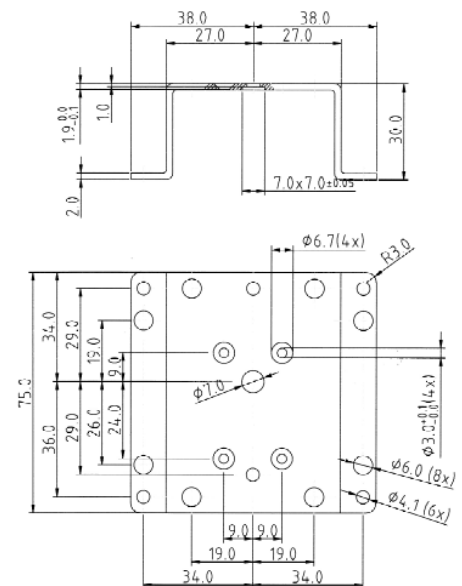

Features an Technical Details:

- extremely compact construction with high rotation torque - up to 100 Ncm stall torque
- even with higher torque not more current consumption - means, up to 6 weeks running period with one D-cell battery (depending on the application and the load)
- robust zinc die casting gear box
- gearing with metal gear wheels, therefore nearly indestructible gear stability
- change of rotation direction by changing connections
- low operating noise
- easy mounting because of appropriate motor bracket and accessory program of the battery motor BM 010 (see next page)

- speed of the three different motor types:

on 1.5 volt:	1.3 /	2 /	4 rpm
on 3 volt:	2.6 /	4 /	8 rpm
on 4.5 volt:	3.9 /	6 /	12 rpm
on 6 volt:	5.2 /	8 /	16 rpm